

## Technical Sheet

### For EIB/KNX Switch Actuator, 8 fold, 10A

ARES-08/10.1

The worldwide STANDARD for home and building control

## DIMENSIONS

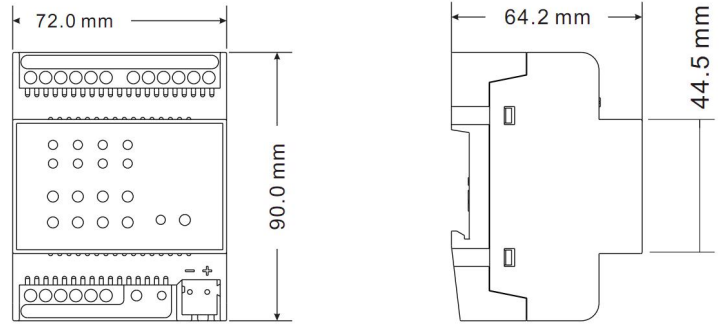

Model	Dimension	Weight
ARES-08/10.1	72 x 90 x 64mm	0.3kg

## CHARACTERISTICS

- Manual operation
- Time functions, on/off delay
- Scene control / presets via 8bit/1bit commands
- Logic operation AND, OR, XOR, gate function
- Status response and Status display
- Forced operation and safety function
- Reaction to threshold functions
- Control of electro thermal valve drives
- Selection of preferred state after bus voltage failure and recovery
- Inversion of the outputs
- Staircase lighting functions with warning and adaptable staircase lighting time.

## DESCRIPTIONS

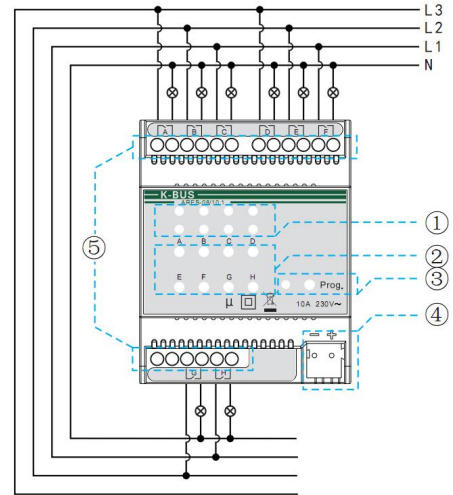

- ① LED, indication status of the outputs
- ② Manual operation, switch on/off the outputs via manual button
- ③ Programming button and LED  
Red LED for entering the physical address, green LED for application process normally running
- ④ EIB/KNX bus connection terminal
- ⑤ Output, load terminal

## PARAMETERS

<b>Power Supply</b>	Operation voltage	21~30V DC, via the EIB bus
	Current consumption	<12mA
	Power consumption	Max.360mW
<b>Output</b>	Number of contacts $U_n$	8
	rated voltage	230V AC (50/60 HZ)
	$I_n$ rated current Min.	10A/230VAC
	load	100mA 5V DC
<b>Operation and display</b>	Red LED and push button	For assigning the physical address
	Green LED flashing	For display the application layer running normally
	Manual buttons	ON/OFF outputs

## INSTALLATION FIGURE

The devices are suitable for installation on the distribution boards with 35mm mounting rail which complies with DIN EN 60715 or a small box in order to facilitate quick installation of the device. Must ensure that the device operation, testing, detecting, maintenance correctly.

## IMPORTANT INFORMATION

Installation and commissioning of the device may only be carried out by trained electricians. The relevant standards, directives, regulations and instructions must be observed when planning and implementing the electrical installation.

- Protect the device against moisture, dirt and damage during transport, storage and operation!
- Do not operate the device outside the specified technical data (e.g. temperature range)!
- The device may only be operated in closed enclosures (e.g. distribution boards).

Should the device become soiled, it may be cleaned with a dry cloth. If this does not suffice, a cloth lightly moistened with soap solution may be used. On no account should caustic agents or solvents be used.

<b>Connections</b>	LED indication of the outputs	LED ON means the output is on LED OFF means the output is off
	EIB/KNX	Bus connection terminal (black/red)
	Load circuits Cable cross-section	Screw terminals Multi-core 0.5-2.5mm <sup>2</sup> Single-core 0.2—4.0mm <sup>2</sup>
<b>Temperature</b>	Operation	-5°C~45°C
	Storage	-25°C~55°C
	Transport	-25°C~70°C
<b>Ambient condition</b>	Humidity	5~85%,except dewing
<b>Installation</b>	On 35mm mounting rail, and on clean, dry indoor	